

DIMENSIONAL DRAWINGS

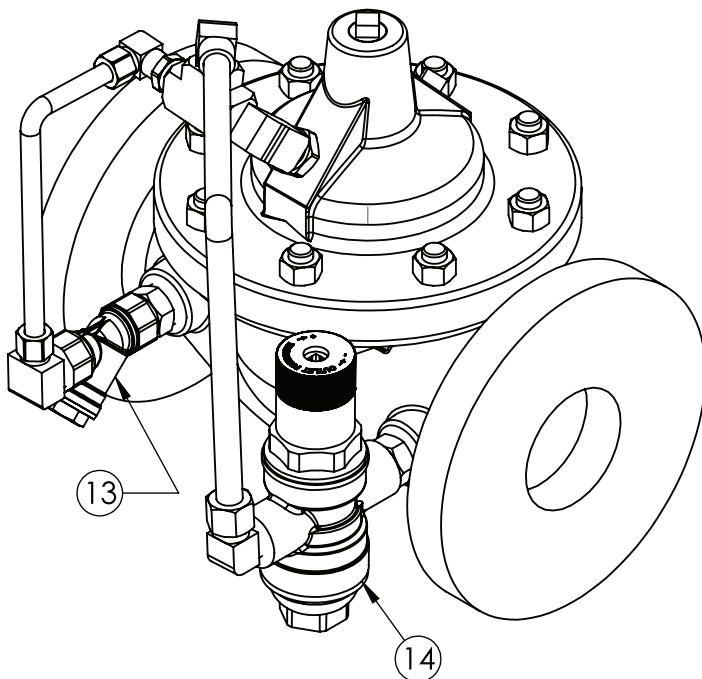
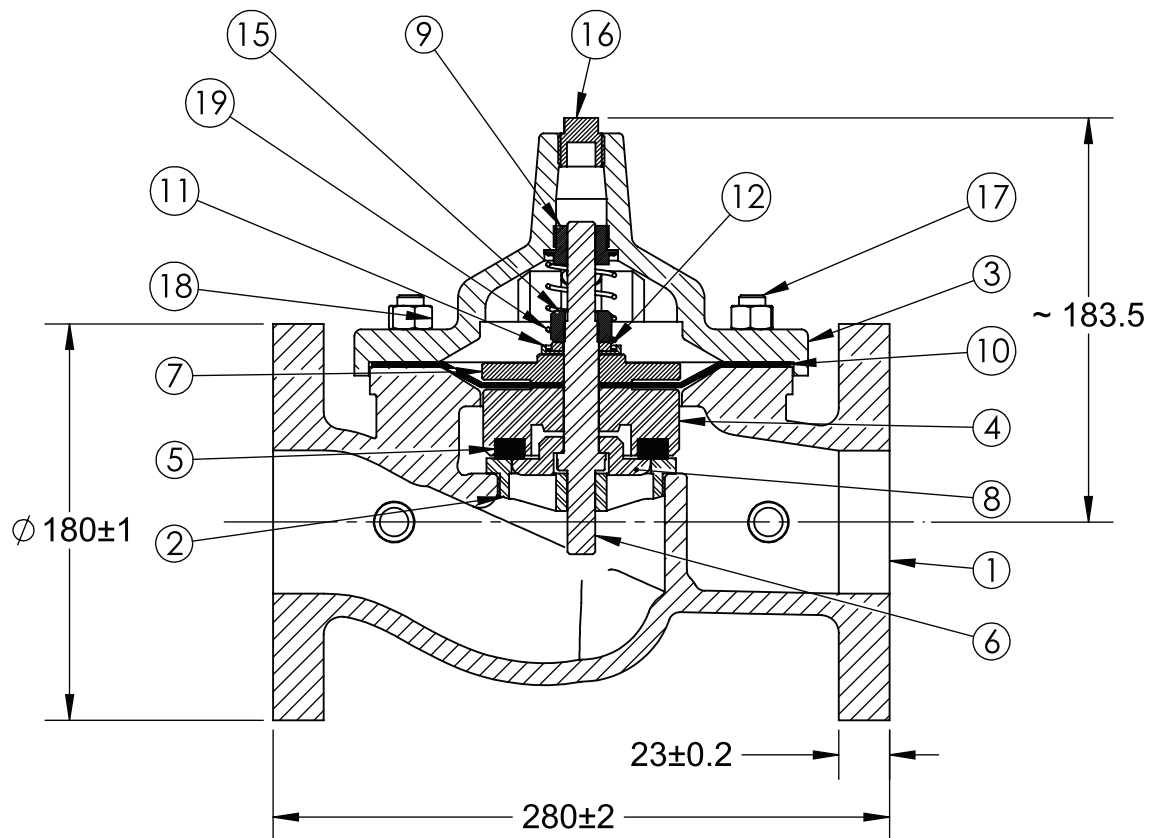

MATERIAL SPECIFICATION

Part No.	Part Name	Material
1	BODY	S.G. IRON (ASTM A536)
2	SEAT RING	S.S. (AISI316)
3	BONNET	S.G. IRON (ASTM A536)
4	DISC HOLDER	S.G. IRON (ASTM A536)
5	DISC	S.S. (AISI316)
6	STEM	S.S. (AISI316)
7	DIAPHRAGM PLATE	S.G. IRON (ASTM A536)
8	DISK WASHER	S.S. (AISI316)
9	BONNET BEARING	S.S. (AISI316)
10	DIAPHRAGM	NBR
11	LOWER SPRING DISC	S.S. (AISI316)
12	STEM WASHER	S.S. (AISI316)
13	STRINER	BRONZE (BS 1400 LG2)
14	PRV	BRONZE (BS 1400 LG2)
15	STEM NUT	S.S. (AISI316)
16	PLUG	S.S. (AISI316)
17	STUDS	M.S.
18	NUTS	M.S.
19	SPRING	SPRING STEEL

TFL Valves Quality Policy Is Complete Satisfaction Of Customers. According To That We Have Selected QUALITY As A Strategic factor in application to all our organization. Our purpose is to reinforce competitiveness, to ensure customer satisfaction, to improve process related with product quality and guarantee accomplishment of quality requirements.